

CONFERENCE ROOM MAP

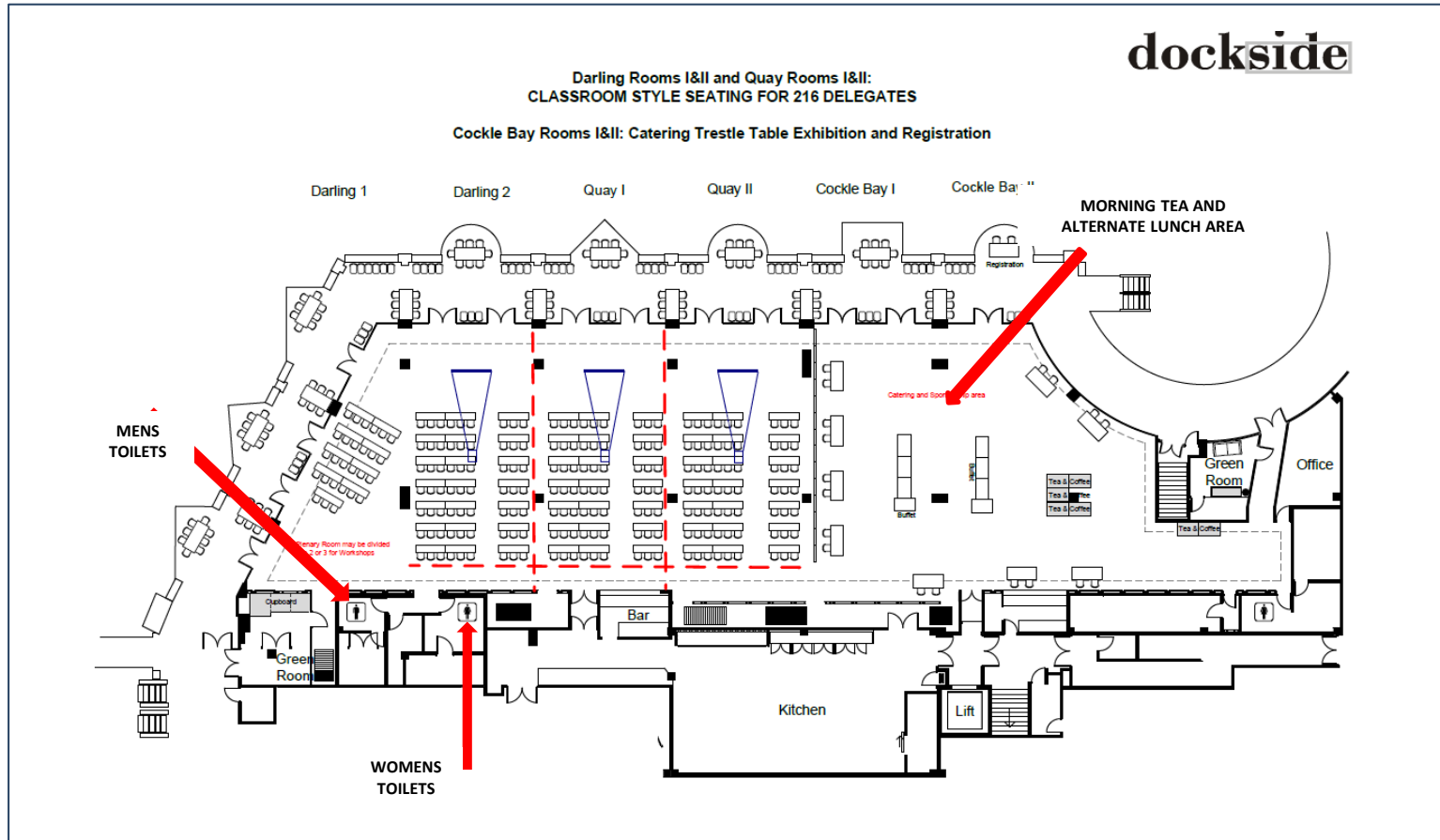

ASU
NATIONAL CONFERENCE
2018

Change
THE RULES

WELCOME RECEPTION MAP

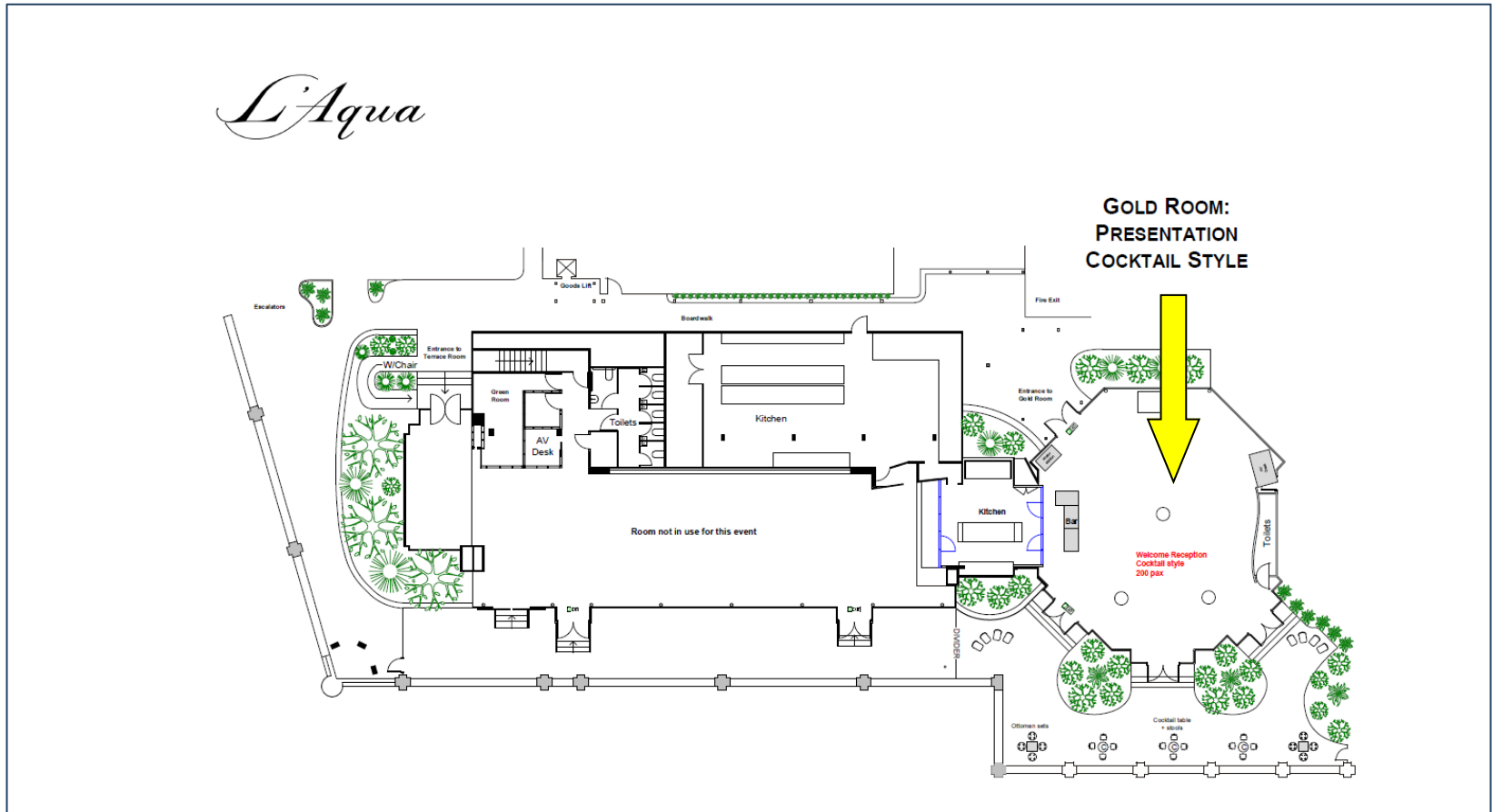

ASU
NATIONAL CONFERENCE
2018

Change
THE
RULES

DAY 2 - WORKSHOPS 1 & 2

dockside

Darling Rooms I&II and Quay Rooms I&II:
CLASSROOM STYLE SEATING FOR 216 DELEGATES

Cockle Bay Rooms I&II: Catering Trestle Table Exhibition and Registration

GROUPS 1 & 2 : PLENARY

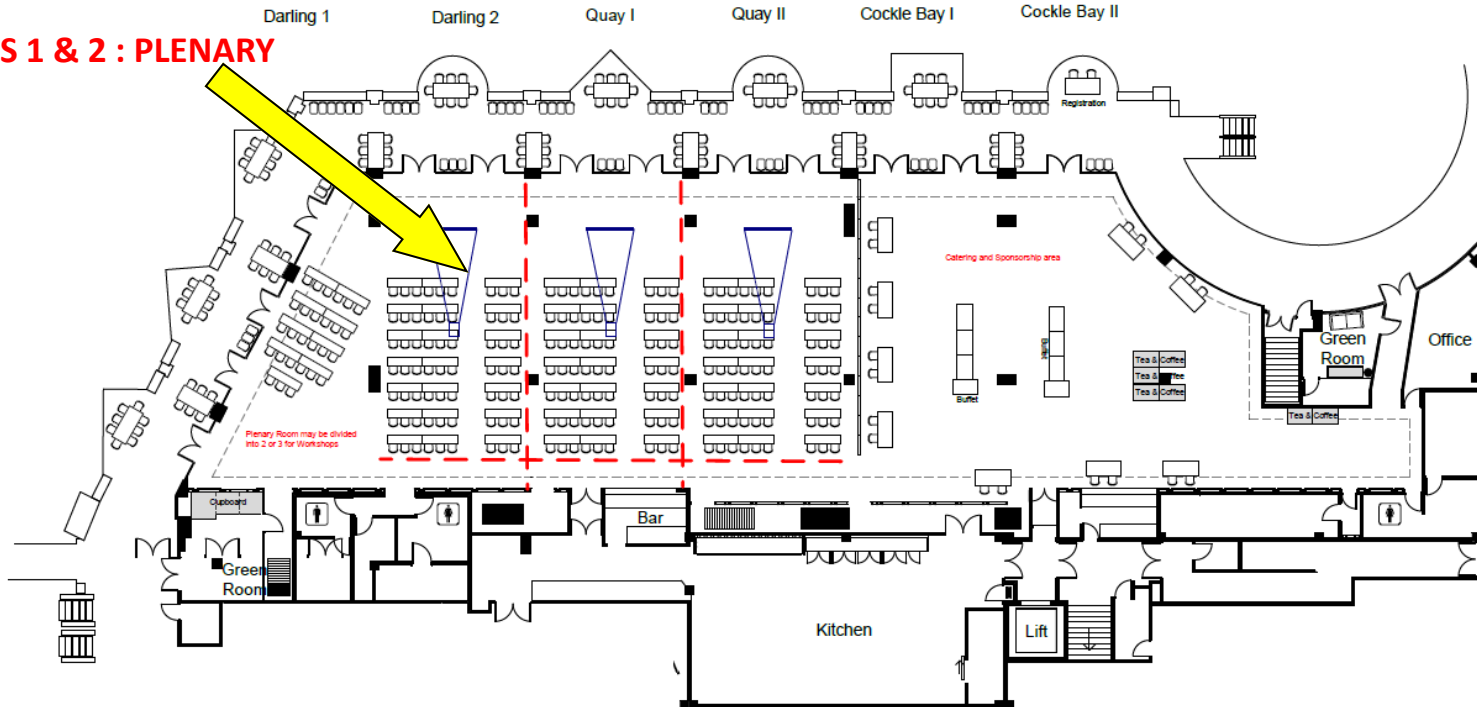

ASU
NATIONAL CONFERENCE
2018

Change
THE RULES

DAY 2 – WORKSHOPS 3 & 4 AND WOMEN’S LUNCH ROOM MAP

L’Aqua

Terrace Room:

Cabaret style seating with 14 tables of 8 delegates per table, seating 112 delegates

GROUPS 3 & 4: TERRACE ROOM

WOMEN’S LUNCH

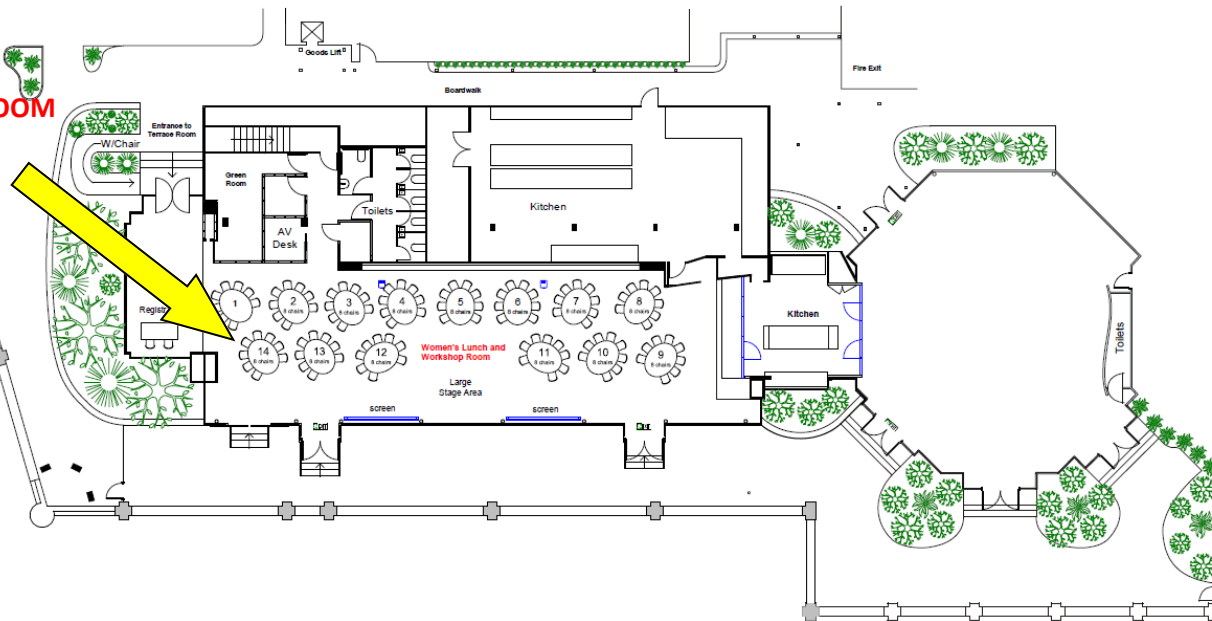

ASU
NATIONAL CONFERENCE
2018

Change
THE RULES

DAY 3 - WORKSHOPS 1, 2, 3 & 4

dockside

Darling Rooms I&II and Quay Rooms I&II:
CLASSROOM STYLE SEATING FOR 216 DELEGATES

Cockle Bay Rooms I&II: Catering Trestle Table Exhibition and Registration

GROUPS 1 & 2: PLENARY

GROUPS 3 & 4: EXHIBITION

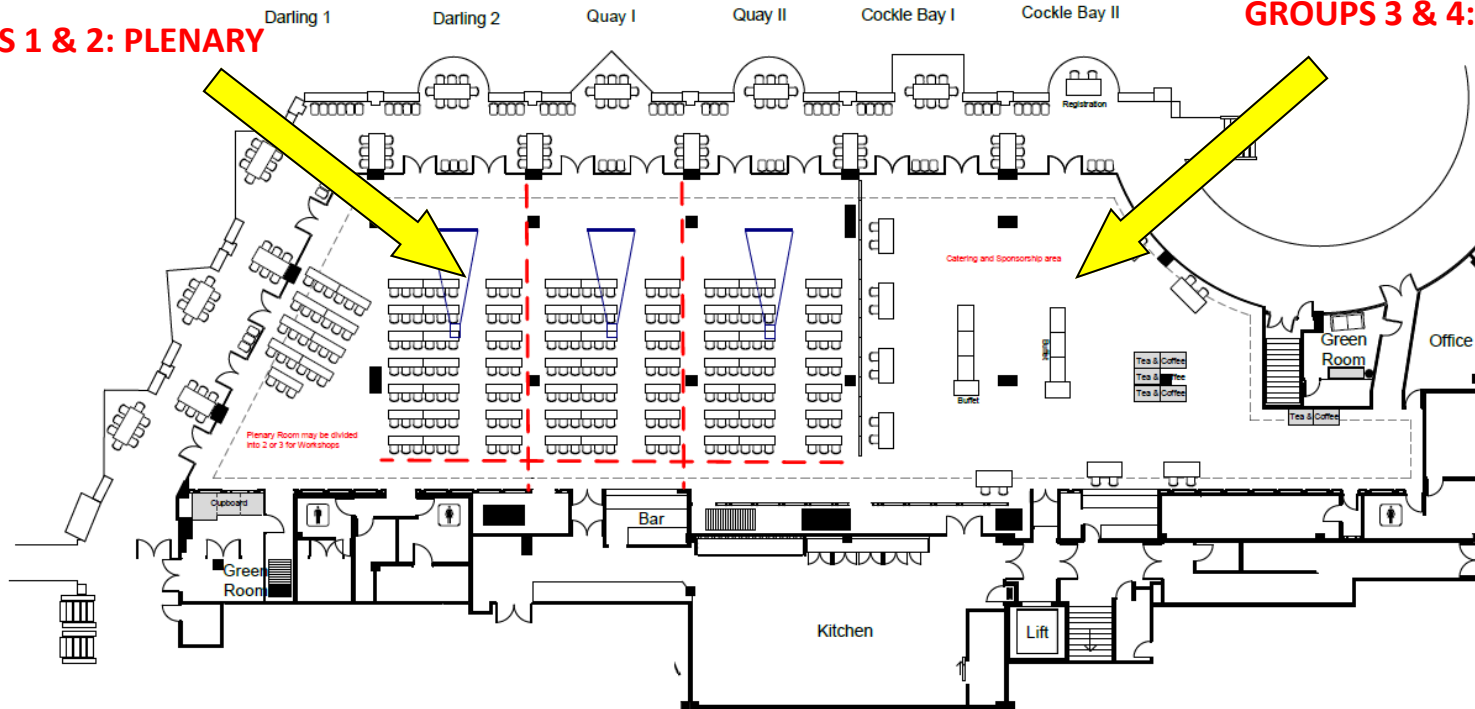

ASU
NATIONAL CONFERENCE
2018

Change
THE
RULES